

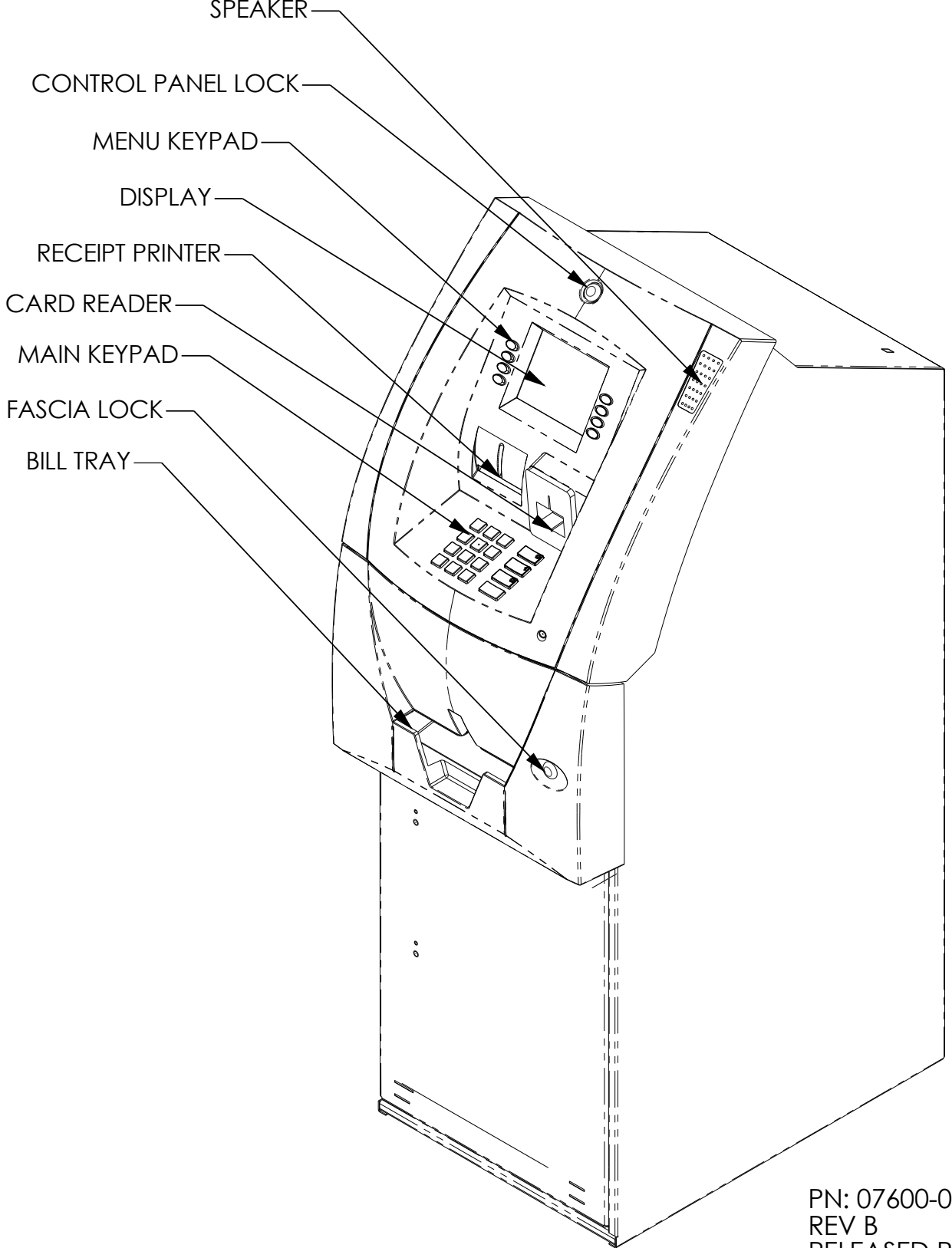

TRITON MODEL 9100 WITH SDD CASH DISPENSER

522 EAST RAILROAD STREET
LONG BEACH, MS 39560
PHONE: (228) 868-1317
FAX: (228) 868-0437

* DIMENSIONS LISTED COMPLY WITH US FEDERAL ADA GUIDELINES. FOR USA INSTALLATIONS, CHECK LOCAL AND STATE GUIDELINES FOR ADDITIONAL GUIDANCE. FOR NON-USA INSTALLATIONS, CHECK REGULATIONS RELATING TO THE COUNTRY OF INSTALL.

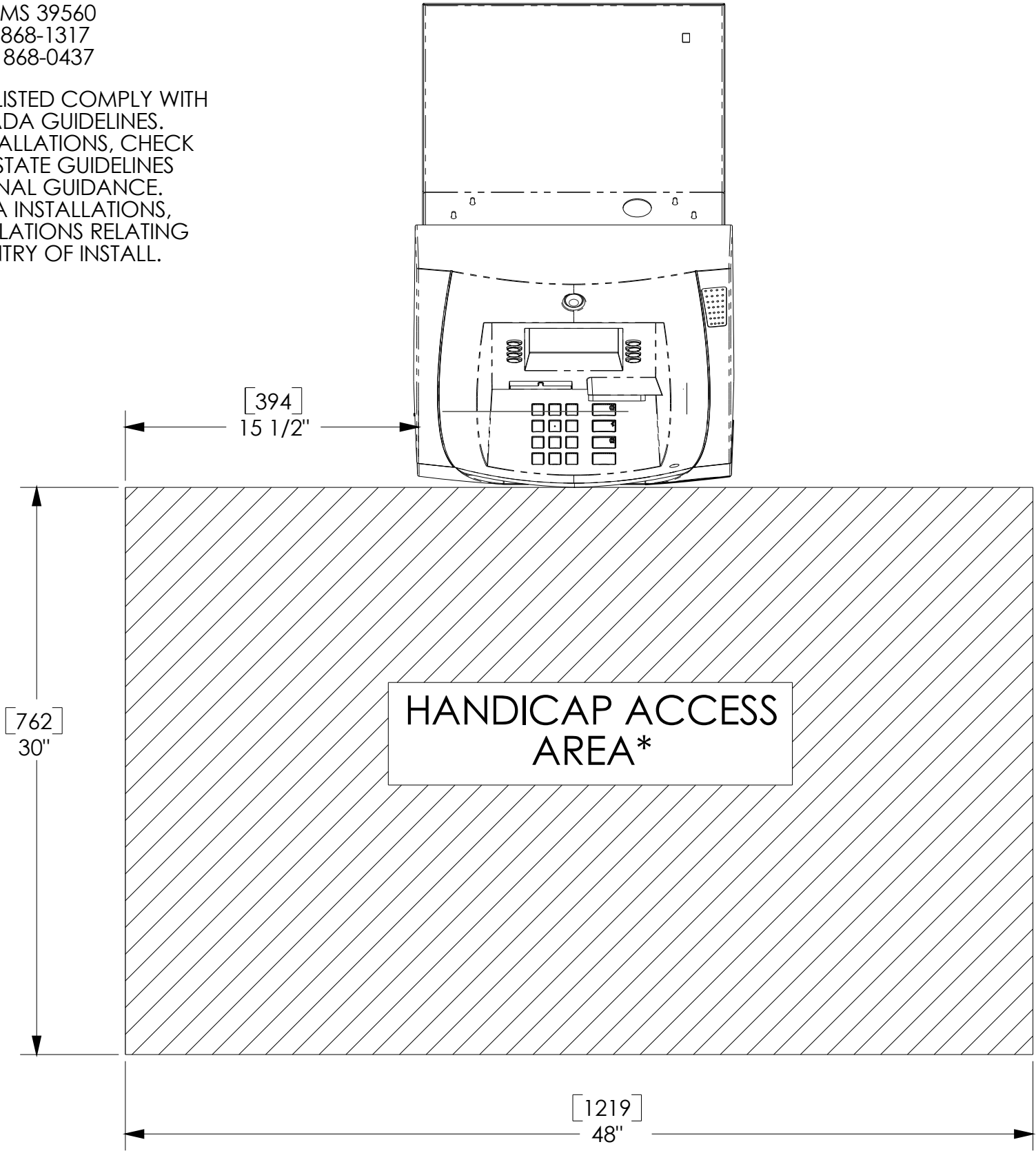

TRITON MODEL 9100 WITH SDD CASH DISPENSER

522 EAST RAILROAD STREET
 LONG BEACH, MS 39560
 PHONE: (228) 868-1317
 FAX: (228) 868-0437

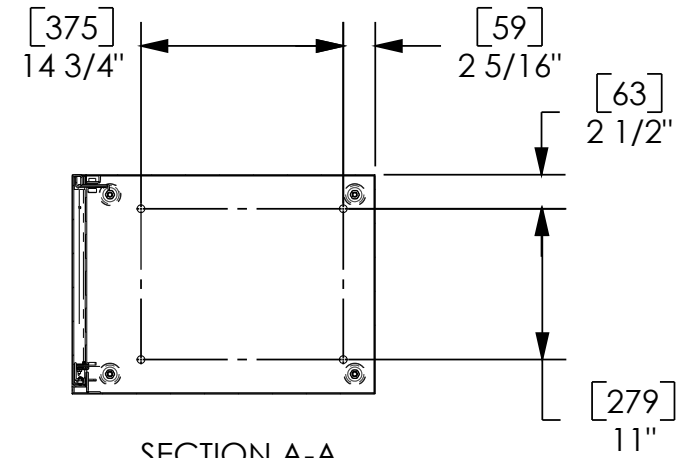
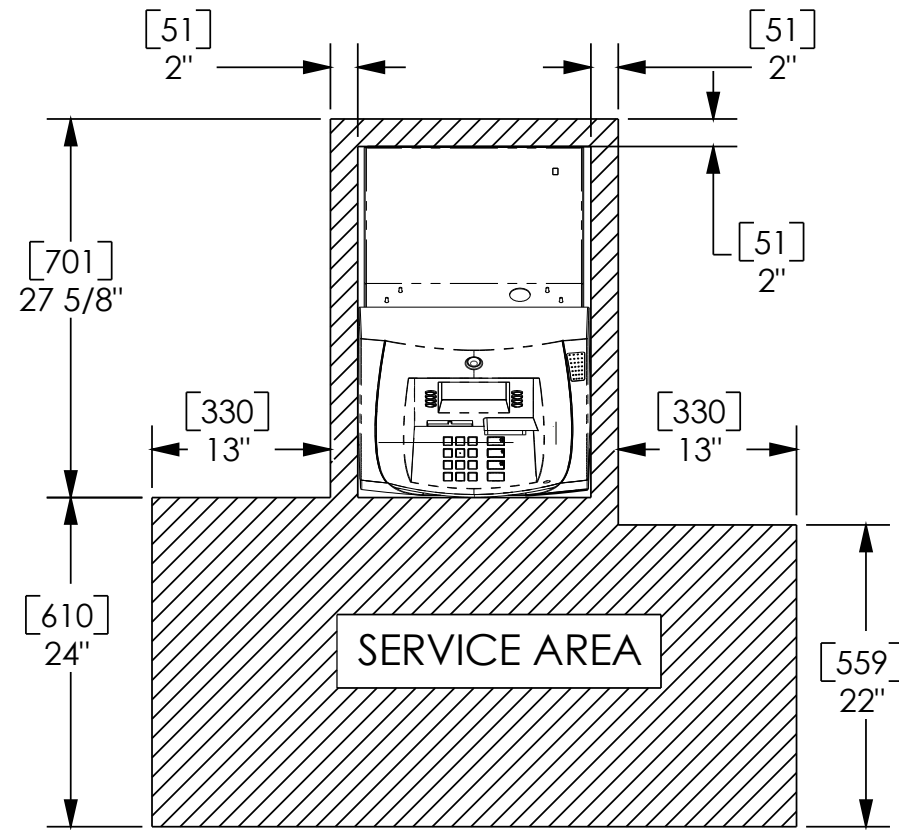

SECTION A-A
 ANCHOR DRILL TEMPLATE

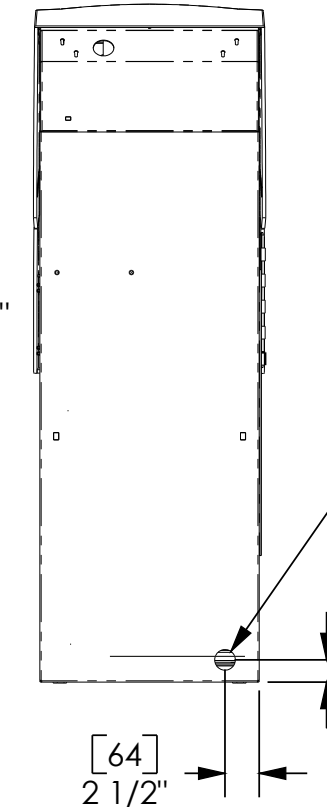
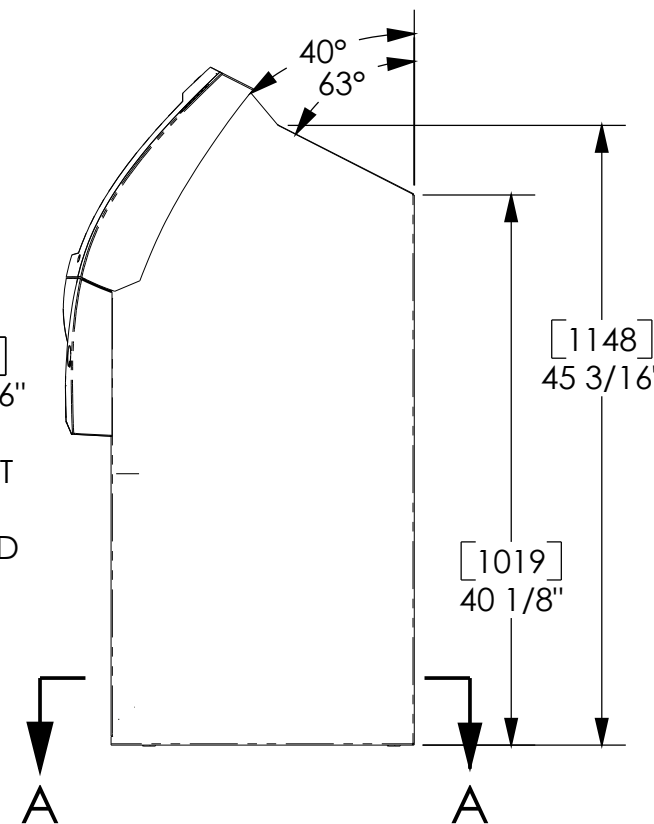
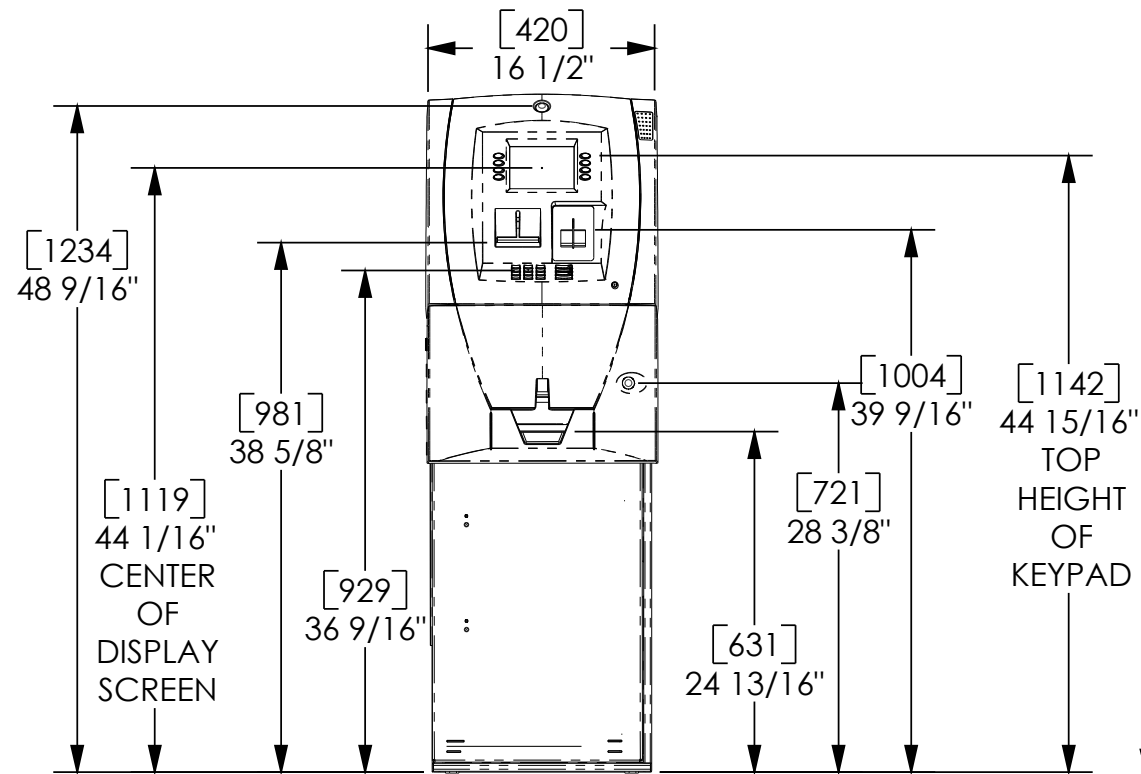

[38]
 Ø1 1/2"
 POWER AND DATA
 CABLE FEED THROUGH

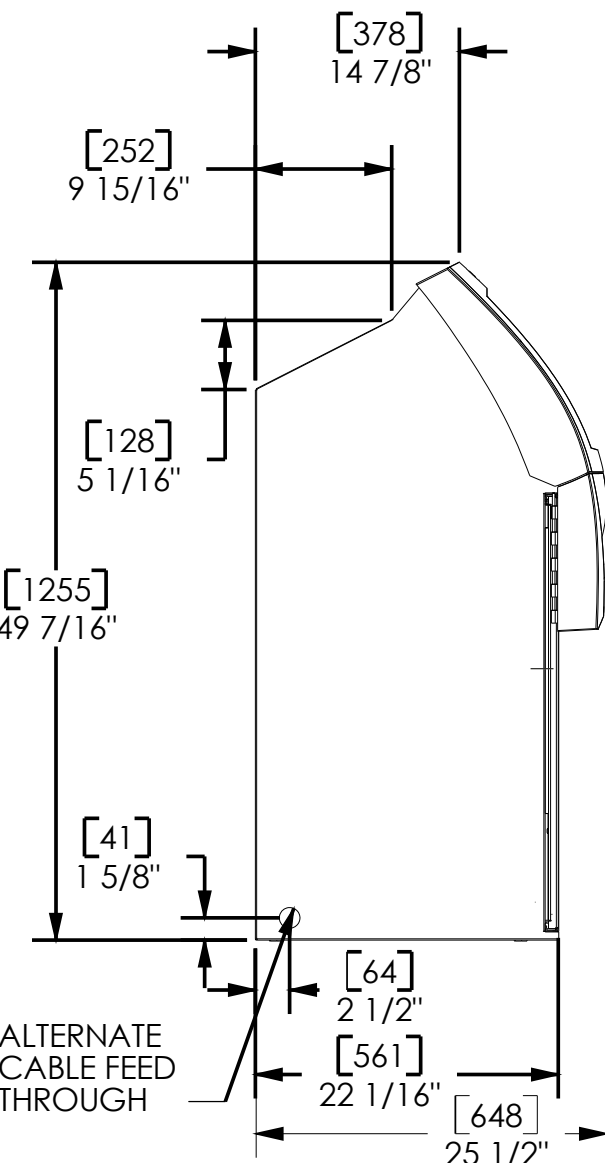

ALTERNATE
 CABLE FEED
 THROUGH



TRITON MODEL 9100 WITH SDD CASH DISPENSER

522 EAST RAILROAD STREET
LONG BEACH, MS 39560
PHONE: (228) 868-1317
FAX: (228) 868-0437

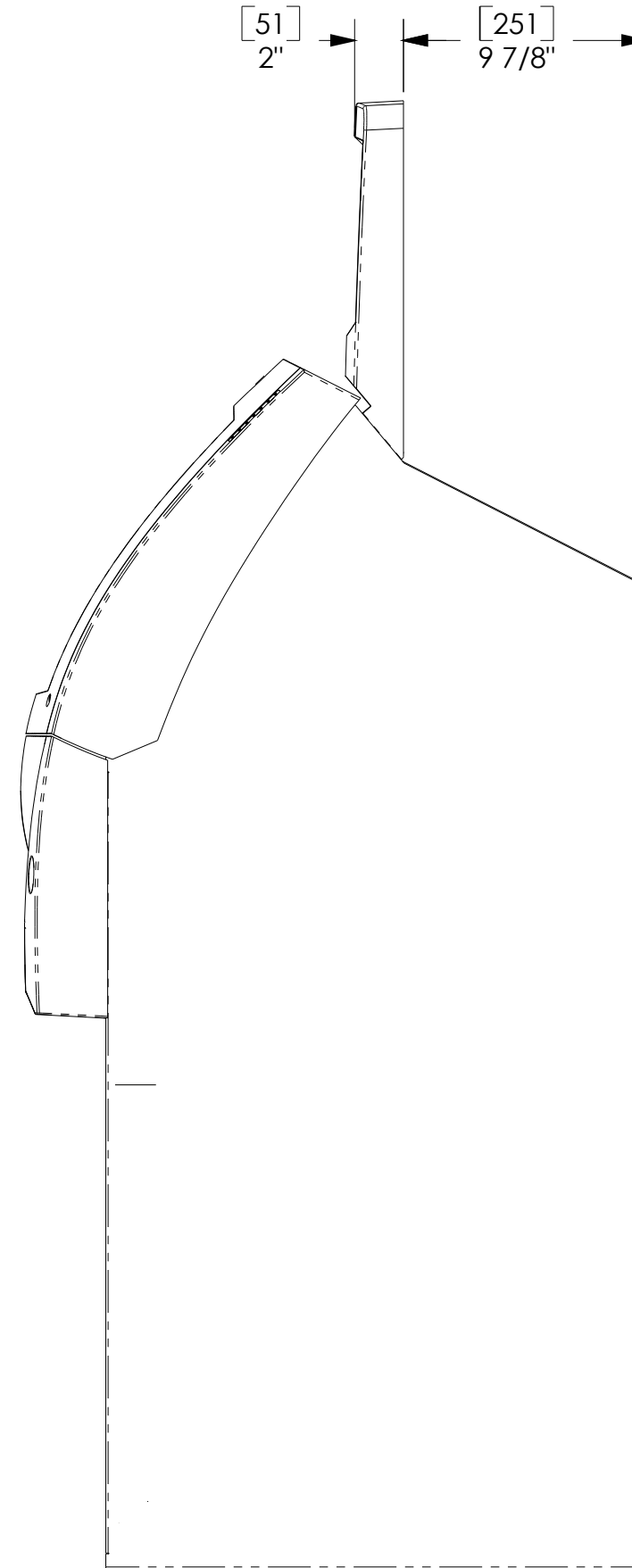
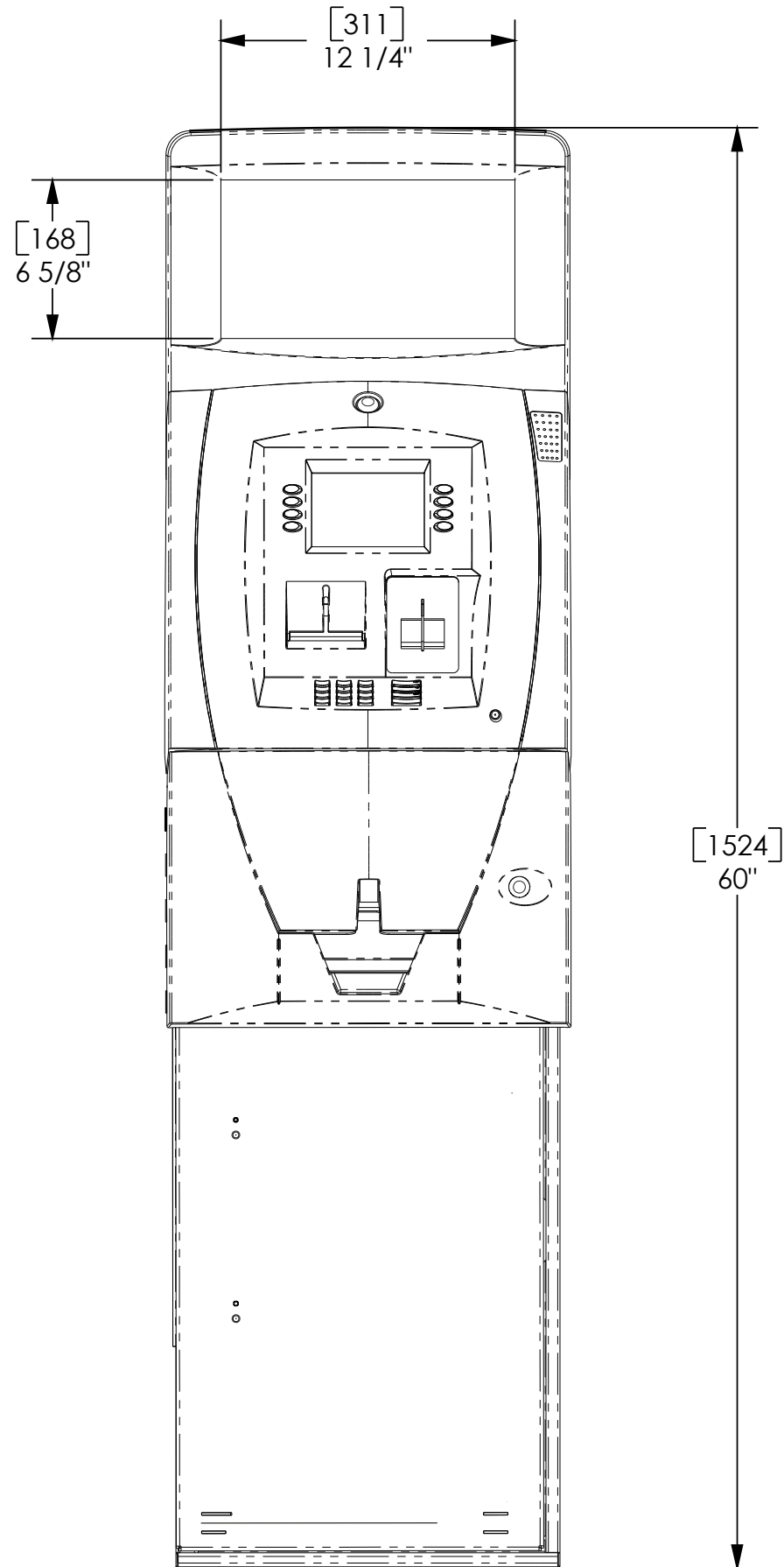



TRITON MODEL 9100 WITH SDD CASH DISPENSER

522 EAST RAILROAD STREET
LONG BEACH, MS 39560
PHONE: (228) 868-1317
FAX: (228) 868-0437

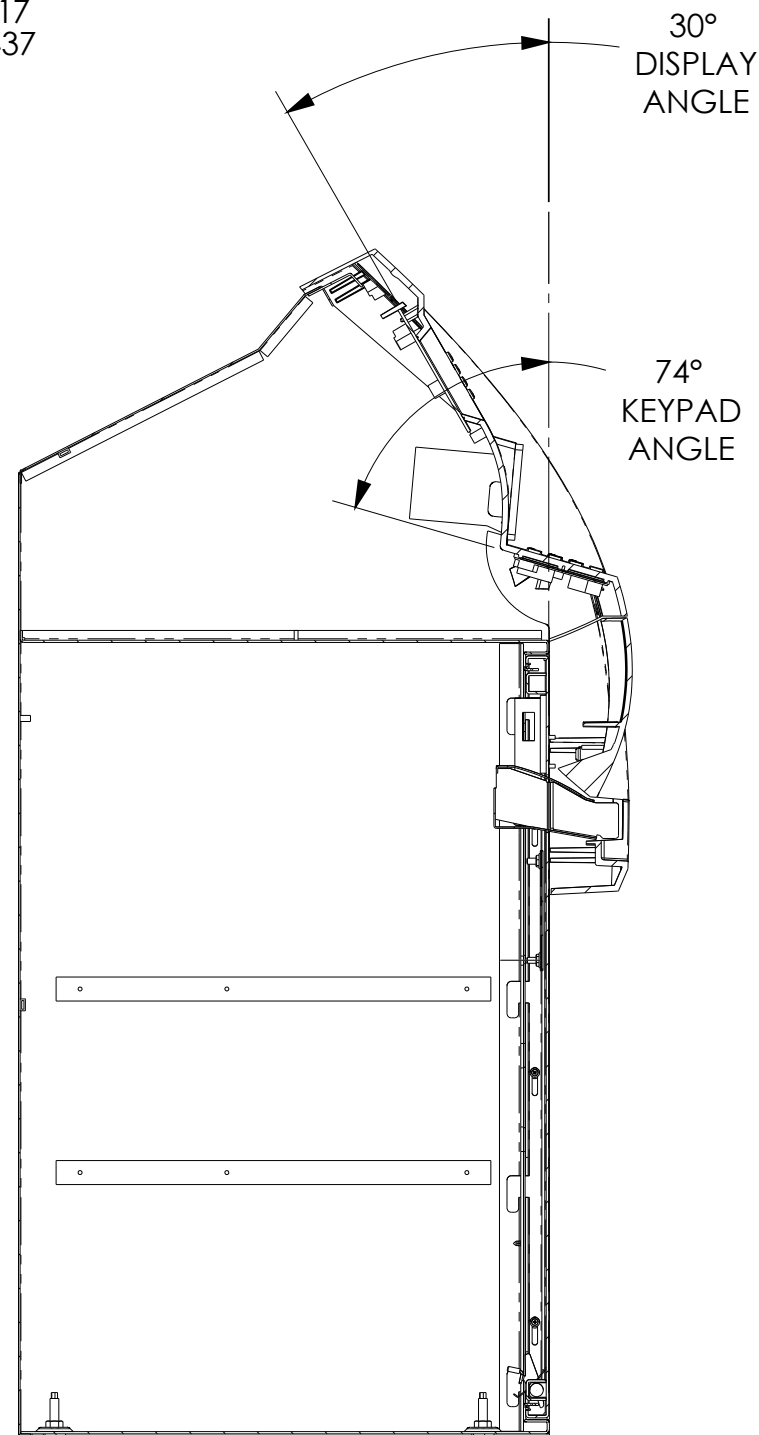

SECTION F-F

D ← | → F

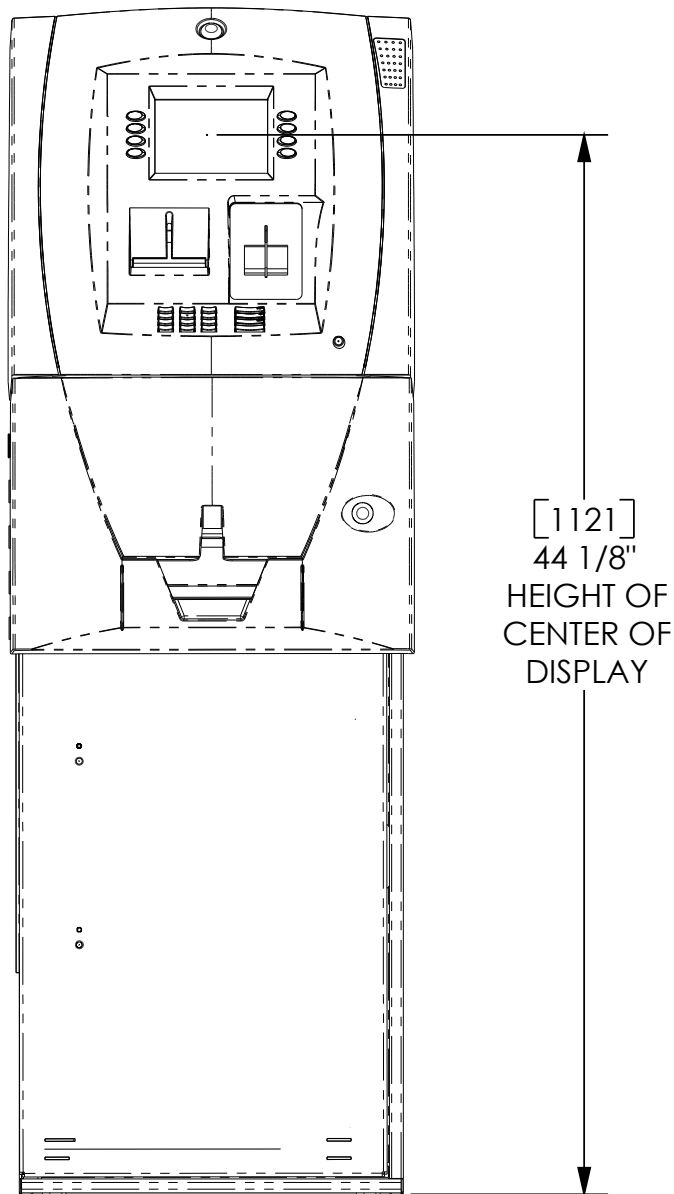

D ← | → F

[191]
7 9/16"
DEPTH OF
TOP SCREEN
BUTTON

[81]
3 3/16"
DEPTH OF
NUMBER 5
KEY

[931]
36 5/8"
HEIGHT OF
NUMBER 5
KEY

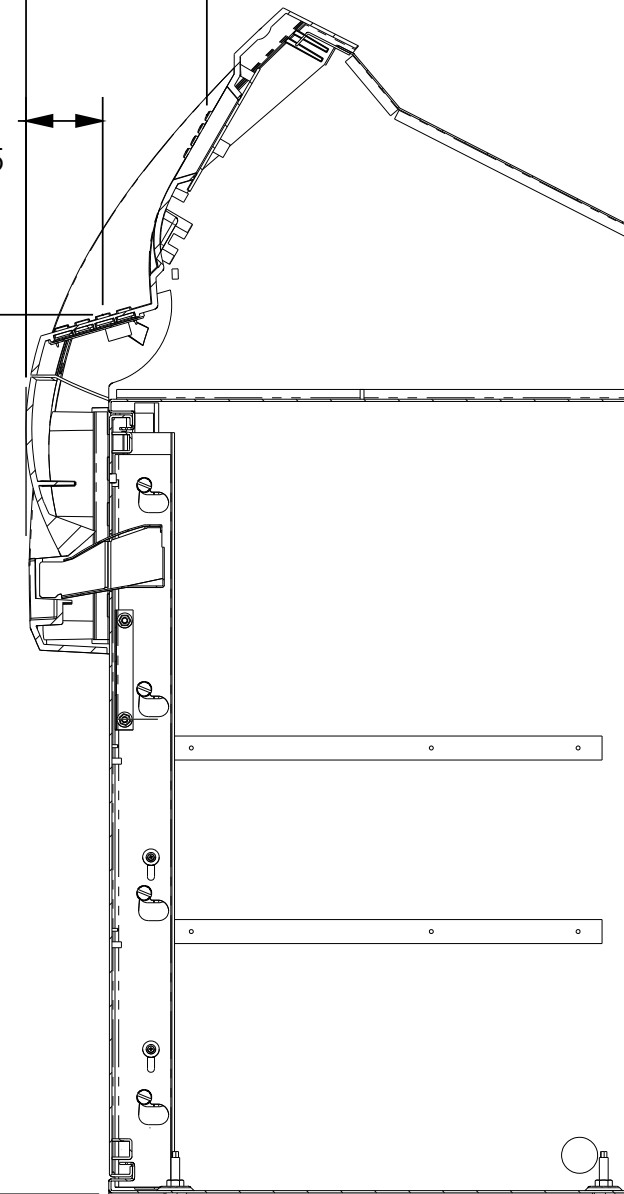

SECTION D-D